

HYAC LCD Display Board - Surface Mount multi layer PCB

with Custom dual microprocessor PCB mounted above

HYAC temperature and state

2 Line LCD

P1

P2

P1 and P2
Climate Control
hardware
interface plugs

Custom Microprocessor

MANUAL Climate Control
button - LED interface

One Wire Encoded temperature,
state and Diag data from HYAC

Dual Zone Climate Control
Microprocessor
and hardware interface

RS232
link

Button, Encoder
and LED I/O
connections

Custom Microprocessor

Steering wheel button
decoder. Backlight
detector for Automatic
PC LCD screen brightness
iDrive decoder & future
ADC/Digital IO interface

Custom Microprocessor

Decoder for temperature
OP state and diag data
from HYAC processor

Encoder logic, button
and LED interface to
and from HYAC processor

Data control and sharing logic

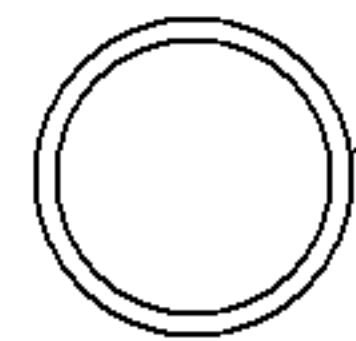

Steering
buttons

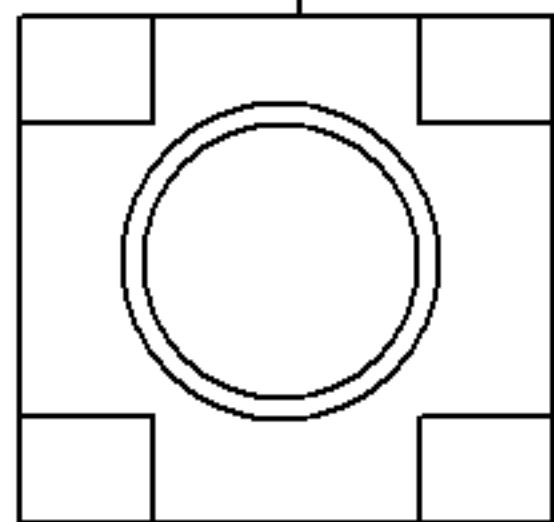

iDrive

USB to PC

Touch Screen Climate
control & Car interface

Audio and Car interface plug
Speaker lines. Perm and Switched Power
Dash Brightness and Lights on detect

Honda Accord G7

HYAC - Modified

Mike

Rev 1.0

11/03/2011

Page 1